

2021 CATALOG

01/01/2021



LAB BENCHES

P 02

LAB CHAIRS

P 06

WIRE SHELVING

P 08

SPECIALTY GAS PARTS

P 10

PLASTICS

P 12

TANK BRACKETS

P 14

617.655.8416

contact@kdmlabsolutions.com



ABOUT OUR BENCHES

KDM Lab Solutions Series 1000 Benches are fully welded for to be able to accommodate all your lab needs. Work surfaces are comprised of 1" thick epoxy for maximum chemical resistance. Table Frames are 6" height adjustable, allowing under counter refrigerators and freezer. Each bench has the capacity for the addition of suspended casework, with multiple sizes and configuration available.

Standard setup includes:

- 5' Bench
- 2 Upright Shelves
- Suspended Casework

Many casework styles available.
View configurations on next page.

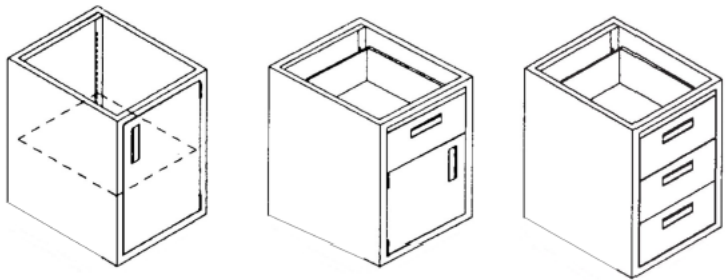

SPECS

HEIGHT 36-42"

DEPTH 60"

COLOR WHITE

CONSTRUCTION WELDED STEEL

LEG CASTERS OR LEVELING FEET

POWER 120 VOLT, 20AMP TWIST
LOCK OR STRAIGHT BLADE

PART NUMBERS

- 4' Bench** - KDM 1000-4830
- 5' Bench** - KDM 1000-6030
- 6' Bench** - KDM 1000-7230

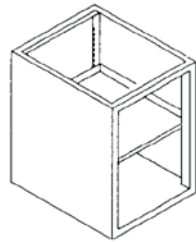

HB2515-000
HB2518-000
HB2524-000
HB2530-000
HB2536-000
HB2542-000
HB2548-000

CASEWORK

Units are available in various widths. Drawers feature full extension slides. A single shelf is standard where shown. Please specify pull styles and right or left hand doors—indicated by side of door where hinges are located.



Recessed Pull



Bar Pull



Wire Pull

Part Numbering System

Sample: HB2530-120

HB= Hanging Base 1= #Doors
25= Height 2= #Drawers
30= Width 0= #Half Drawers
 L= Features

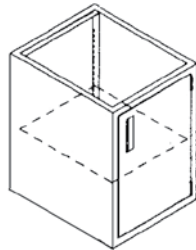

HB2515-100(R)
HB2518-100(R)
HB2524-100(R)

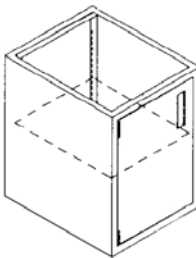

HB2515-100(L)
HB2518-100(L)
HB2524-100(L)

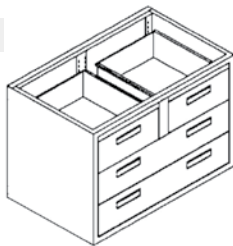

HB2530-040
HB2536-040
HB2542-040
HB2548-040



HB2530-060
HB2536-060
HB2542-060
HB2548-060



HB2515-030
HB2518-030
HB2524-030

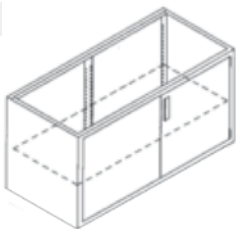

HB2530-100(RorL)SP
HB2536-100(RorL)SP
HB2542-100(RorL)SP
HB2548-100(RorL)SP

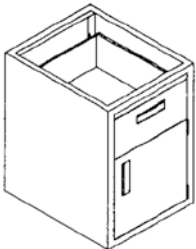

HB2515-110(R)
HB2518-110(R)
HB2524-110(R)

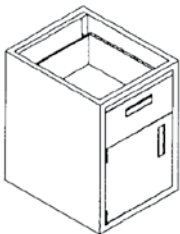

HB2515-110(L)
HB2518-110(L)
HB2524-110(L)

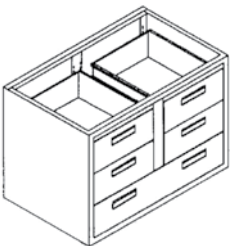

HB2530-050
HB2536-050
HB2542-050
HB2548-050

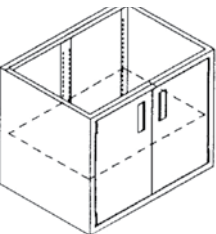

HB2530-200
HB2536-200
HB2542-200
HB2548-200

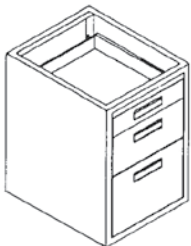

HB2515-B11
HB2518-B11
HB2524-B11



HB2530-110(L)SP
HB2536-110(L)SP
HB2542-110(L)SP
HB2548-110(L)SP

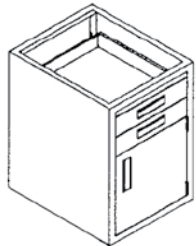

HB2515-102(R)
HB2518-102(R)
HB2524-102(R)

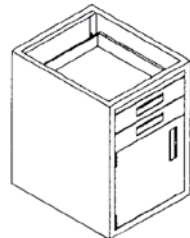

HB2515-102(L)
HB2518-102(L)
HB2524-102(L)

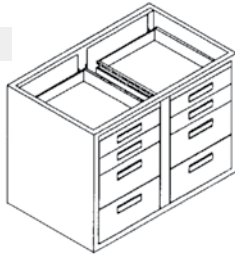

HB2530-044
HB2536-044
HB2542-044
HB2548-044

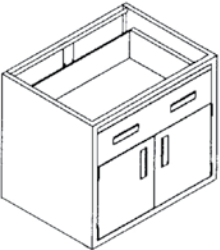

HB2530-210
HB2536-210
HB2542-210
HB2548-210



HB2515-022
HB2518-022
HB2524-022

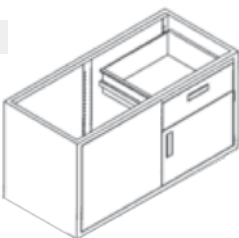

HB2530-110(R)SP
HB2536-110(R)SP
HB2542-110(R)SP
HB2548-110(R)SP

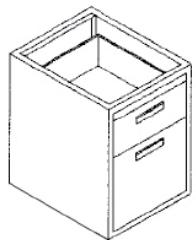

HB2515-F10
HB2518-F10
HB2524-F10

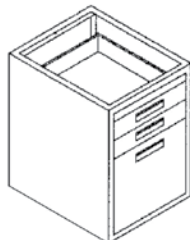

HB2515-F02
HB2518-F02
HB2524-F02

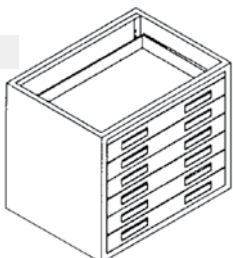

HB2530-006
HB2536-006
HB2542-006
HB2548-006

NEED HELP?

For questions or help with a custom configuration call 617-655-8416.

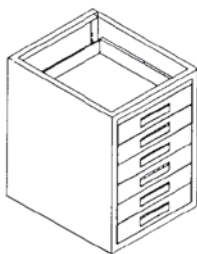

HB2515-006
HB2518-006
HB2524-006

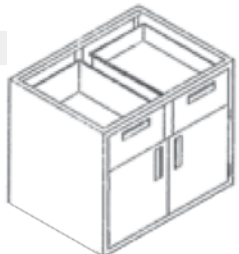

HB2530-220
HB2536-220
HB2542-220
HB2548-220

QUALITY LAB CHAIRS

KDM Lab Solutions Lab Chairs are purpose built for comfort and durability. All surfaces are washable for easy disinfection. Our lab chairs are fully adjustable and come with an optional foot ring. Desk height chairs work great with bio-safety cabinet applications.

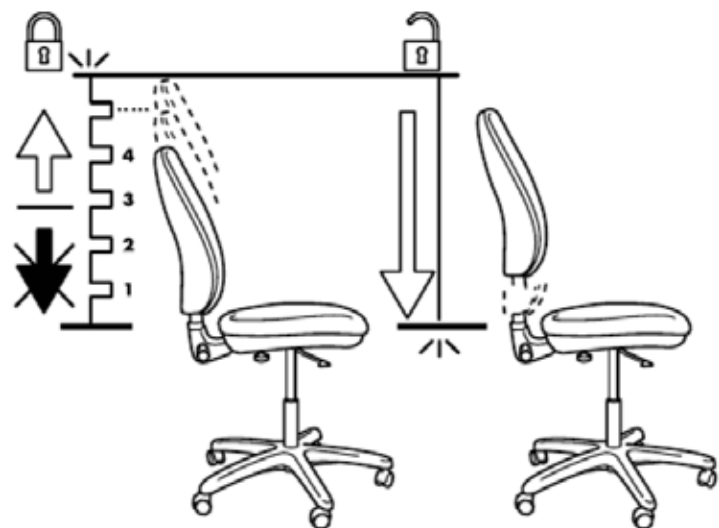

SPECS
DESK HEIGHT 17-22" ADJUSTABLE
BENCH HEIGHT 21-31" ADJUSTABLE
COLOR BLACK
CONSTRUCTION STEEL
FEET CASTERS
SWIVEL 360 DEGREES
PART NUMBERS
For bio-safety cabinets (no foot ring) - PBAM12-V-FLC
With foot ring - PBAM10-V-FLC



LAB
CHAIRS



Chrome Steel
Construction.

Chrome Wire
Shelving.

High Density Skates &
Tracks Available.

SHELVING SYSTEMS

We offer a full range of chrome wire shelving with varying sizes for multiple applications. Ask us about our high density shelving to maximize the available storage in your lab.

Shelving Add-Ons

- High Density Shelves and skates



SPECS

WIDTH 4-6'

DEPTH 12-24"

COLOR CHROME

CONSTRUCTION STEEL

LEG CASTERS OR LEVELING FEET

OTHER HIGH DENSITY SLIDING
SHELVING AVAILABLE

PART NUMBERS

12" DEEP SHELF
4' Wide - WR74-1248C
5' Wide - WR74-1260C
6' Wide - WR74-1272C

18" DEEP SHELF
4' Wide - WR74-1848C
5' Wide - WR74-1860C
6' Wide - WR74-1872C

21" DEEP SHELF
4' Wide - WR74-2448C
5' Wide - WR74-2460C
6' Wide - WR74-2472C

WIRE
SHELVING

SPECIALTY GAS PARTS

We offer a full range of laboratory grade plumbing fixtures. From lab sink faucets to specialty gas regulators, to custom configurations.

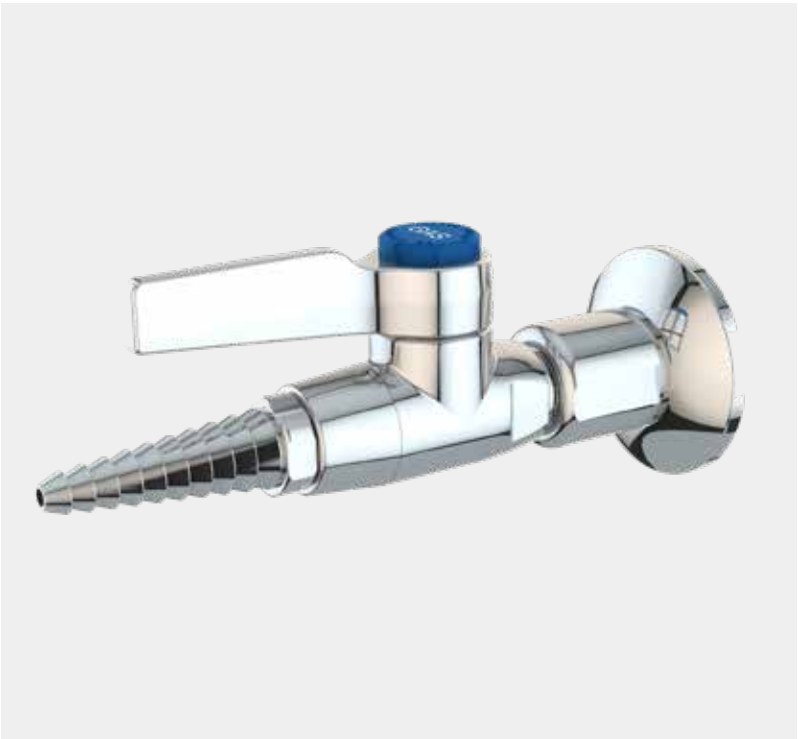

SPECS

COLOR CHROME

PART NUMBERS

LAB FAUCETS

- Faucet** - L412VB
- Blade Handles** (pictured right) - L412VB-BH
- 3 Piece Faucet** - L2210BH

BALL VALVES

- With shank and mounting nut** - L4200-158WSA
- Valve (pictured left)** - L4200-158FT

SPECIALTY GAS REGULATOR

- Regulator** - L3173-366-758WSA
- Single Regulator & Quick Connect Fitting** - L4203-364-178FT

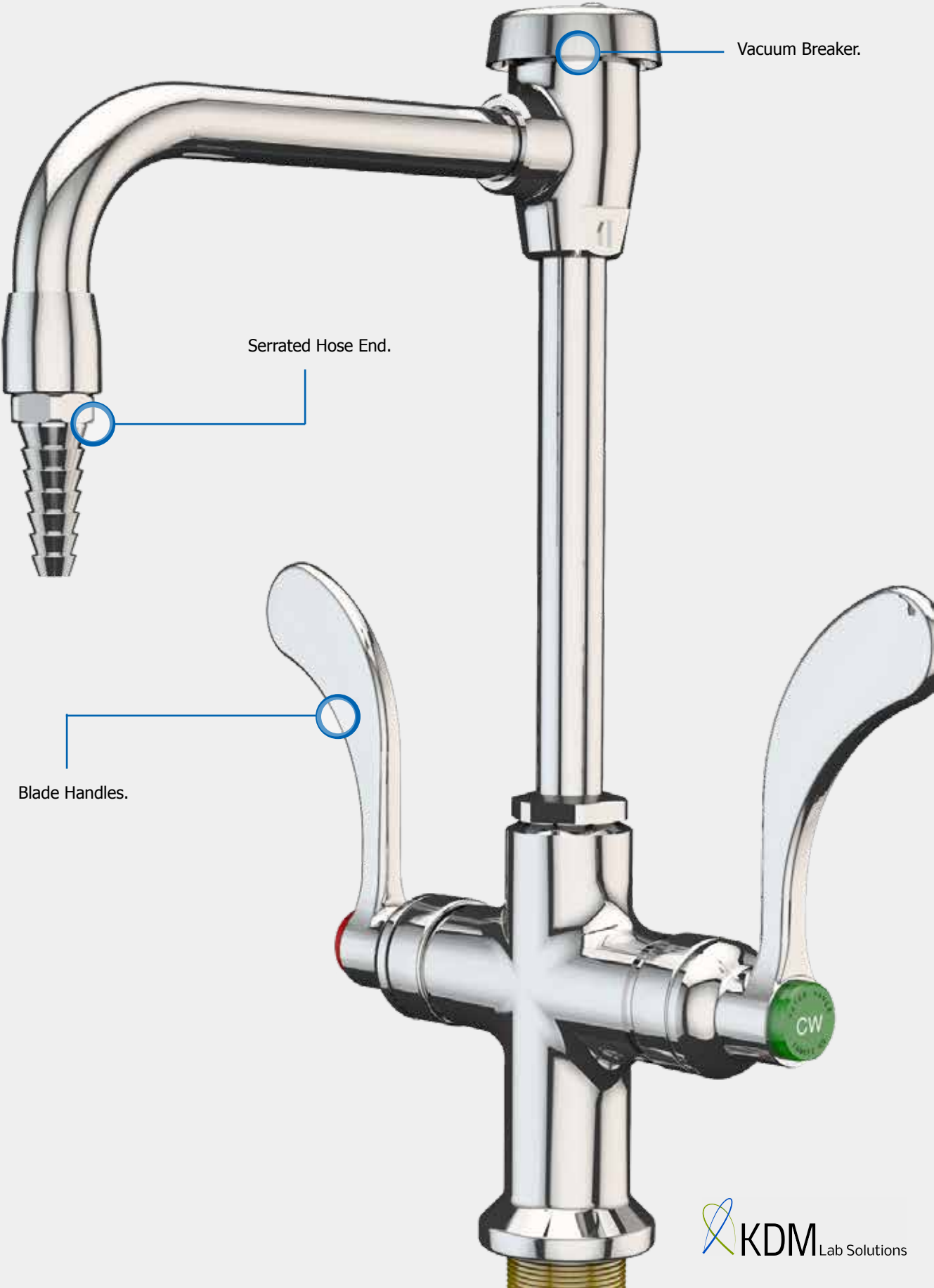

GAS
PARTS



CC-Cart-A2 Includes Integral Space for Sharps Container.

Fully-Welded Polypropylene Construction.

PLASTICS

From simple mounting stock to cell culture carts and clear enclosures we offer a full line of standard and custom plastic products. Ask about our acrylic pegboards, and cell culture carts and pipette holders. Get your lab organized with our solutions to your everyday needs.



SPECS

MATERIALS

POLYPROPYLENE
ACRYLIC
POLYCARBONATE

COLOR MULTIPLE AVAILABLE

PART NUMBERS

POLYCARBONATE ENCLOSURE
Pictured left - Model A

CELL CULTURE CARTS
Cart - CC-Cart-A1
With integral space for
Sharps container - CC-Cart-A2

ACRYLIC PEGBOARDS
1" Thick, 24W x 30H - APBPGB2430
1" Thick, 18W x 24H - APBPGB1824

PLA-
STICS

TANK BRACKETS

We offer a full range of tanks brackets to meet your lab needs. Single, double, triple wall mounted, floor mounted, bench mounted.



SPECS
MOUNT TYPES FLOOR, WALL, BENCH
CONSTRUCTION STEEL OR ALUMINUM
PART NUMBERS
WALL MOUNT
Single Tank Bracket - Y99-241500
Double Tank Bracket - Y99-G200
Triple Tank Bracket - Y99-241500
BENCH MOUNT
Single Tank Bracket - Y99-242200
FLOOR
Double Tank - Y99G275

BRACK-
ETS

